



Birlea

Suppliers of inspiration

Vendor: S000350



ASSEMBLY INSTRUCTIONS **URBAN 2 DOOR 2 DRAWER SIDEBORD RUSTIC**

IMPORTANT : READ THESE INSTRUCTIONS CAREFULLY BEFORE ATTEMPTING TO ASSEMBLE OR USE YOUR URBAN 2 DOOR 2 DRAWER SIDEBORD RUSTIC.

PLEASE KEEP THESE INSTRUCTIONS FOR FUTURE REFERENCE.

ASSEMBLY:

Assembly should be carried out with this item laying flat, not standing upright.

Assemble on a soft, clean surface to prevent damages.

To erase the numbers printed on the pieces, use the rubber inside the accessories pack.

HEALTH & SAFETY:

DO NOT use this product if any parts are missing, damaged or worn.

DO NOT use this product unless all fixings are secured.

Always use on a level, even surface.

CARE & MAINTENANCE:

Periodically check all screws & fixings to ensure they are secure.

DO NOT push the product as this will cause damage.

Always lift the product with two people to reposition.

Keep any sharp objects away from the product.

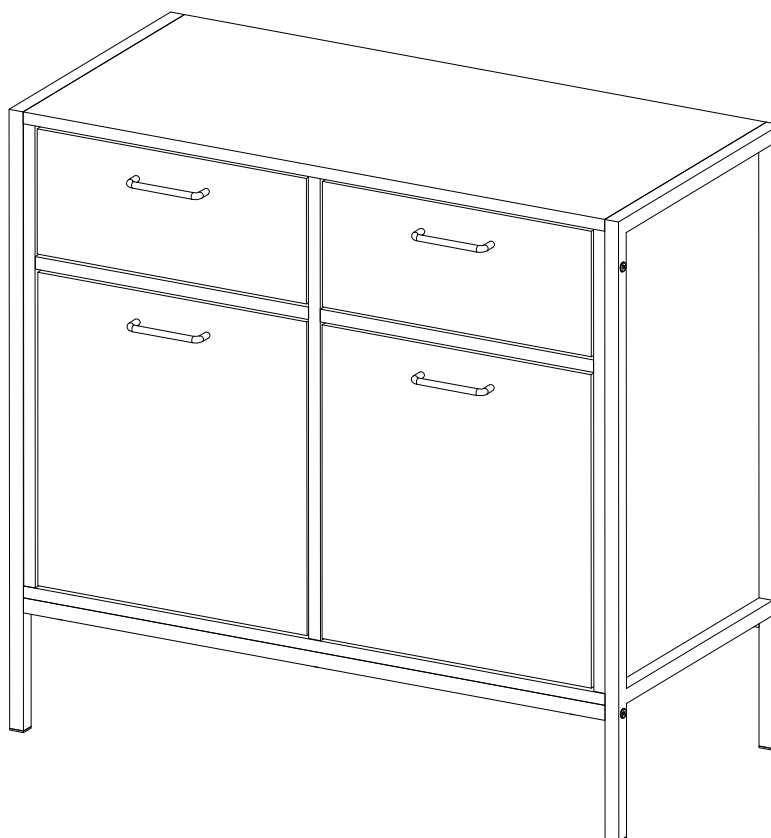

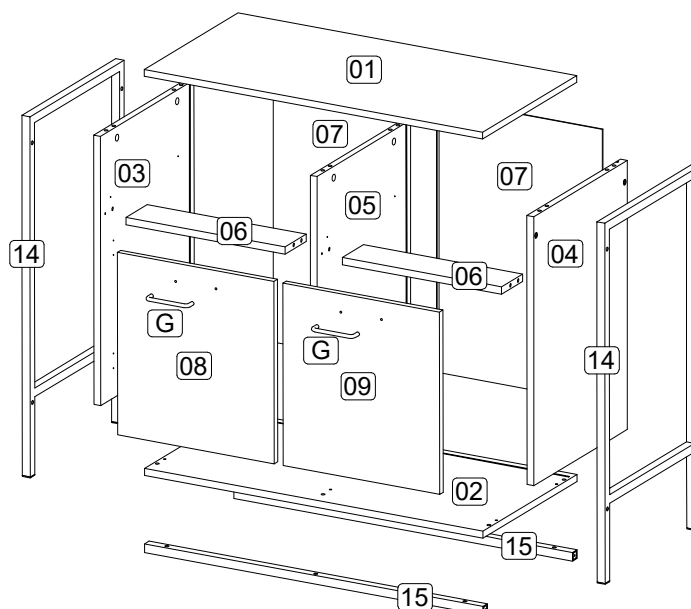
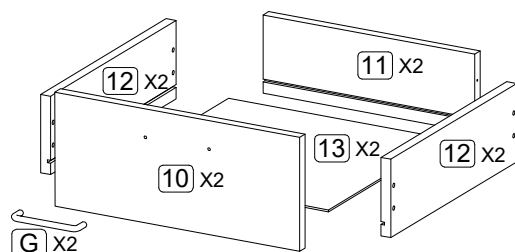

Parts List			Hardware List		
Part	Description	Qty	Part	Description	Qty
01	Top panel	1	A1	Cam lock	10
02	Bottom panel	1	A2	Minifix screw	10
03	Side panel (Left)	1	A3	Plastic cap	10
04	Side panel (Right)	1	B	M8 x 30mm Wood Dowel	16
05	Center Panel	1	C	M6 x 50mm CSK Cap Wood screw	6
06	Bone Panel	2	D	Allen key M4	1
07	Back Panel	2	E	M3.5 x 16mm C.B Screw	42
08	Door Panel (Left)	1	F	M4 x 38mm C.B Screw	16
09	Door Panel (Right)	1	G	Handle 100.96. BLM	4
10	Drawer Front	2	H	Handle screw M4 x 19mm	8
11	Drawer Back	2	I	JCBC screw M6 x 30mm	10
12	Drawer Side	4	J	JCBC screw M6 x 40mm	4
13	Drawer Bottom	2	K	7/8 Hinges	4
14	Metal Frame Side	2	L1	Stud 192	8
15	Metal Frame Middle	2	L2	Stud 192 screw	8
** You will need a small mallet and a screwdriver for assembly. ** Some screws and wooden dowel may remain. ** Note : To secure the item to the wall, hardware F (2 pcs) and P (2 pcs) are not provided.			M1	14" Drawer slide (Left / Right)	4
			M2	14" Drawer slide (Left / Right)	4
			N	Stopper (2 Pin)	2
			O	8" x 1" PP tape	2
			P	Wall plug	-

Step 1: Prepare these parts for assembly using hardware parts A1, A2, B, E, G, H, K, M1 and N.
DO NOT use any power tools as this may damage the frame and will invalidate any claim.

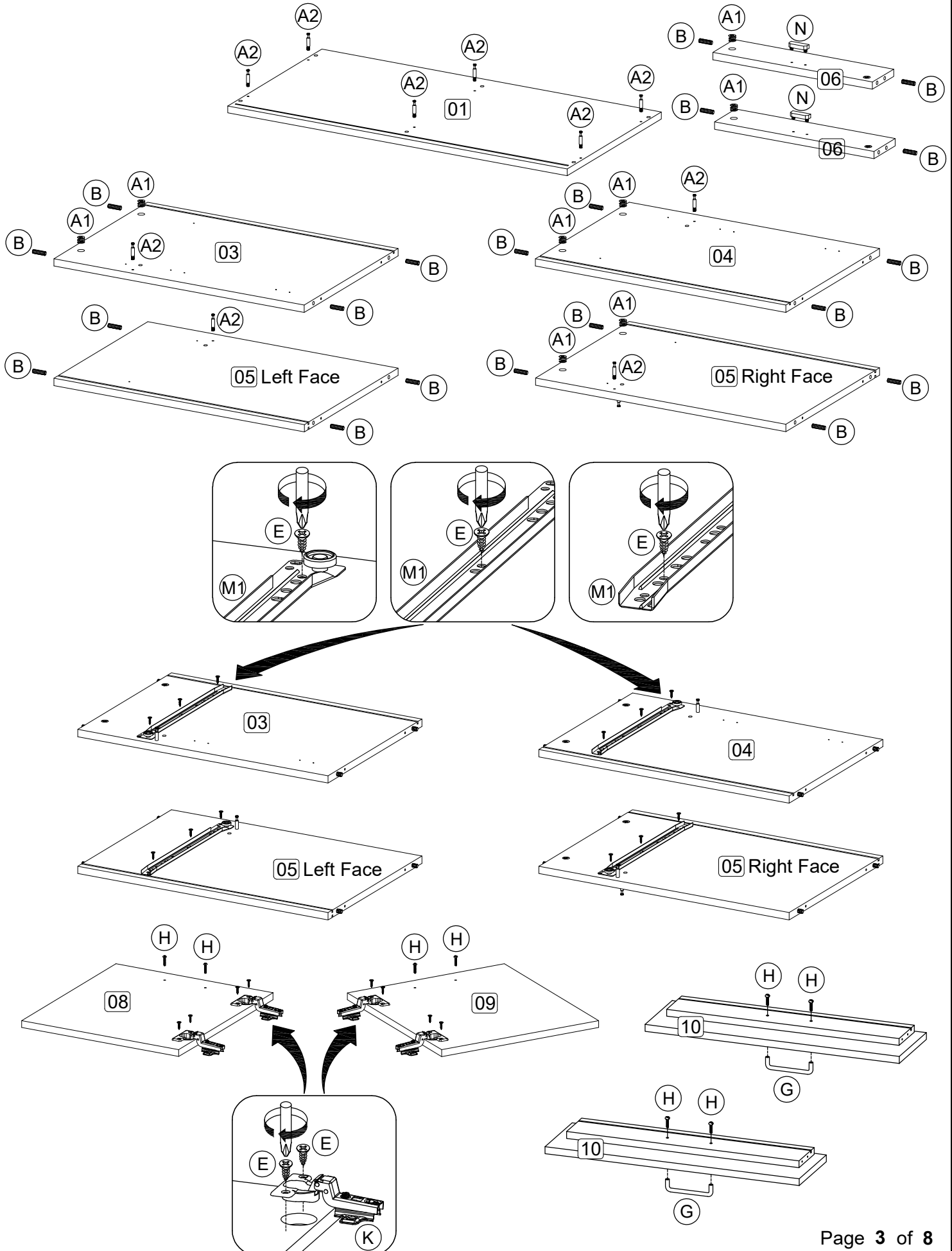

Step 2: Attach panel (3), (4) and (5) to panel (6) using hardware A1, A2 and A3 with a screwdriver (not provided).
DO NOT use any power tools as this may damage the frame and will invalidate any claim.

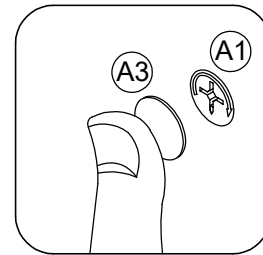
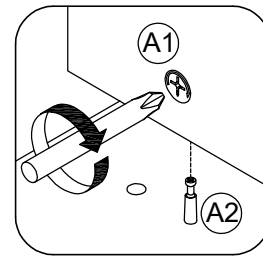
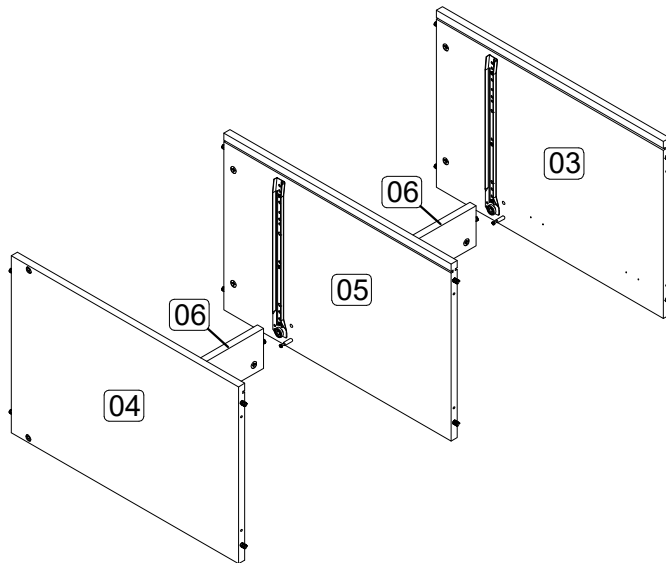

Step 3: Attach panel (3), (4) and (5) to panel (1) using hardware A1, A2 and A3 with a screwdriver (not provided).
DO NOT use any power tools as this may damage the frame and will invalidate any claim.

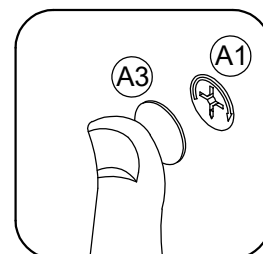
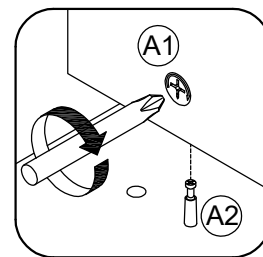
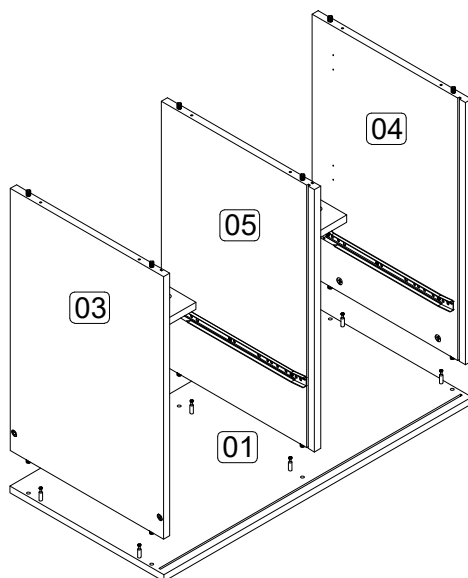

Step 4: Insert panel (7) along the slot.
DO NOT use any power tools as this may damage the frame and will invalidate any claim.

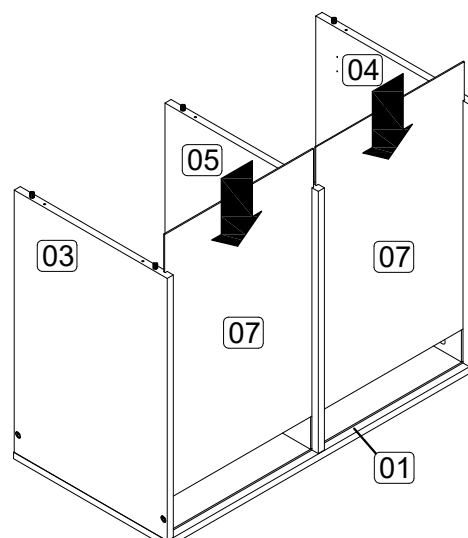

Step 5: Attach panel (2) to panel (3), (4) and (5) using hardware C and D.

DO NOT use any power tools as this may damage the frame and will invalidate any claim.

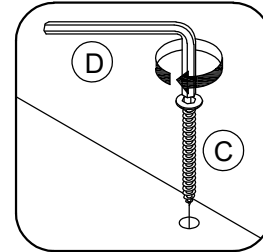
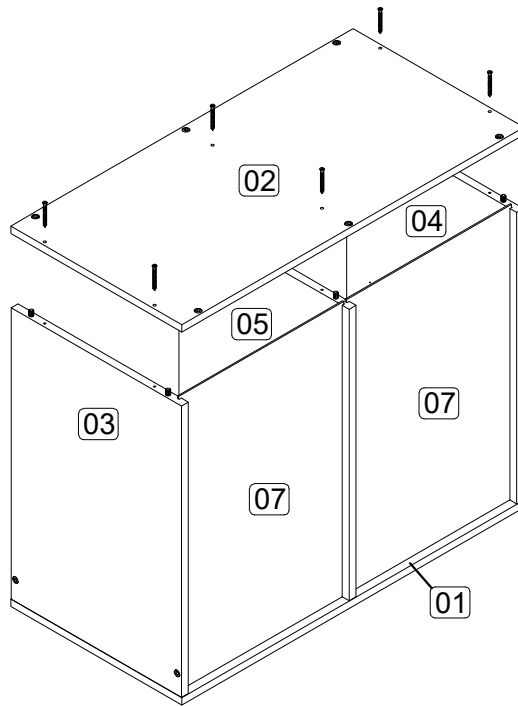

Step 6: Attach hardware L1 into panel (1), (2), (3) and (4) using hardware L2 with a screwdriver (not provided).

DO NOT use any power tools as this may damage the frame and will invalidate any claim.

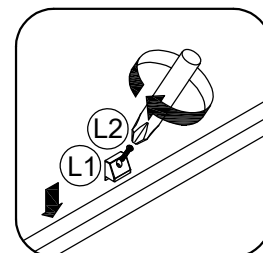
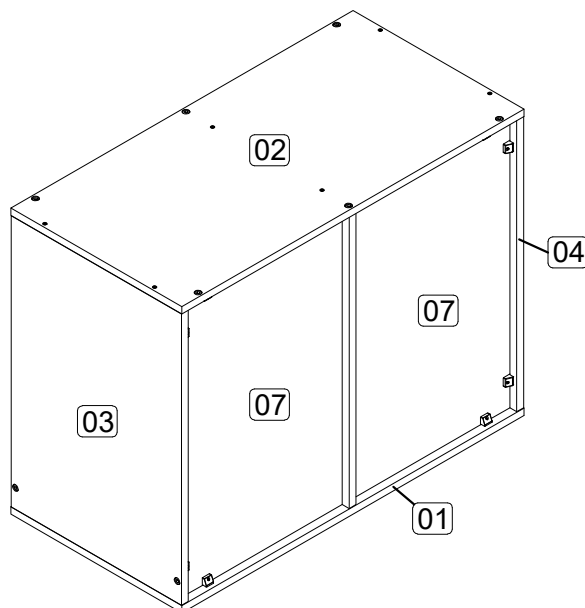

Step 7: Attach Metal Frame Middle (15) to panel (2) using hardware D and I.

DO NOT use any power tools as this may damage the frame and will invalidate any claim.

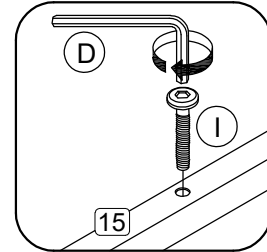
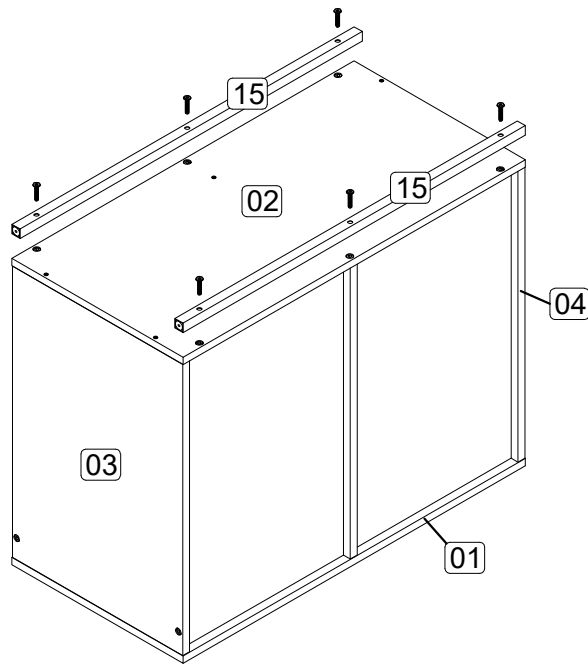

Step 8: Attach Metal Frame Side (14) to panel (3) and (4) using hardware D and I.

Attach Metal Frame Side (14) to Metal Frame Middle (15) using hardware D and J.

DO NOT use any power tools as this may damage the frame and will invalidate any claim.

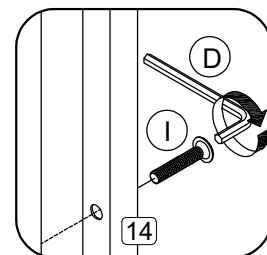
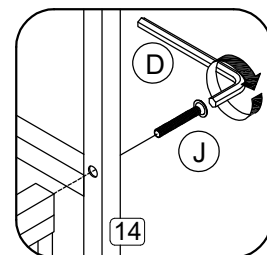
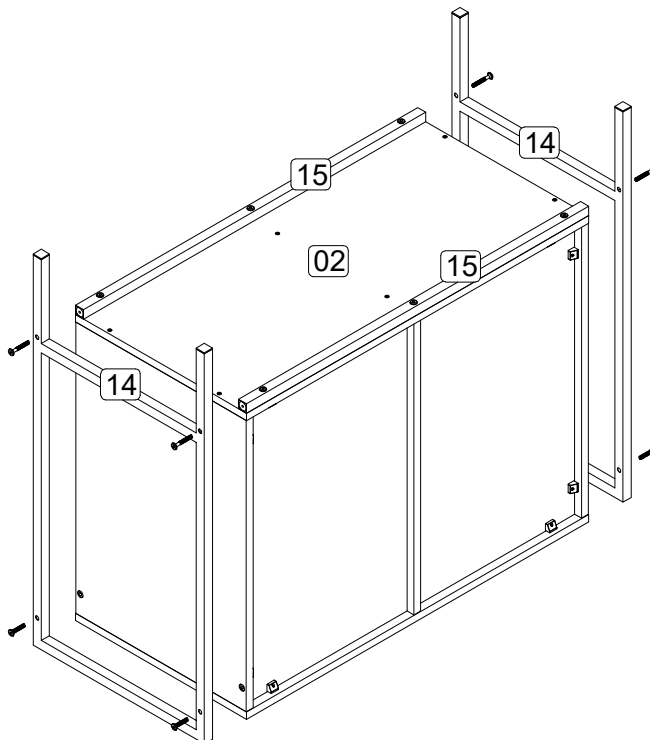

Step 9: Attach panel (8) and (9) to panel (3) and (4) using hardware E with a screwdriver (not provided).
DO NOT use any power tools as this may damage the frame and will invalidate any claim.

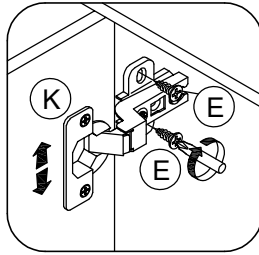

Vertical
Adjustment

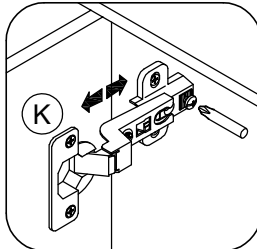

Horizontal
Adjustment

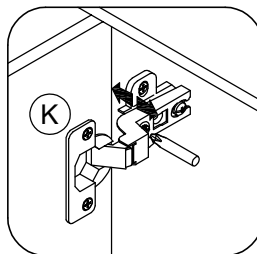

Depth
Adjustment

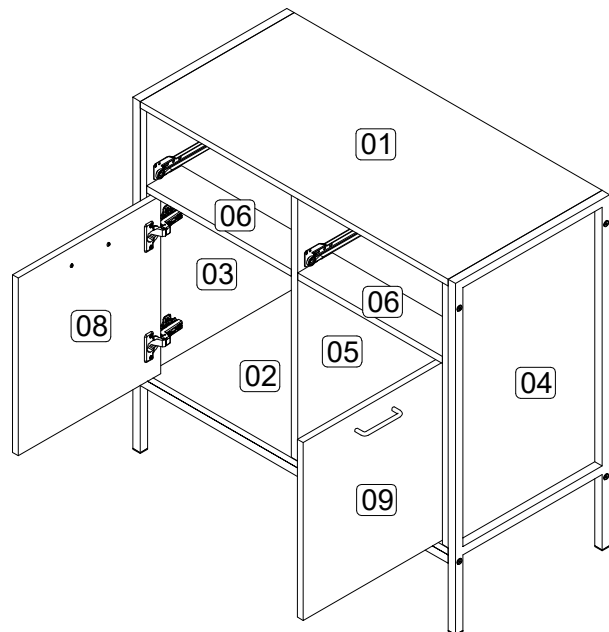

Step 10: Assemble the drawer components using hardware E, G and M2.

In this step only show one of the drawers.

DO NOT use any power tools as this may damage the frame and will invalidate any claim.

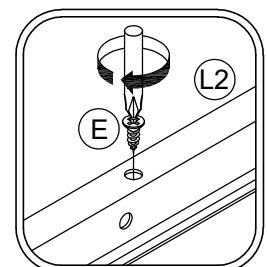
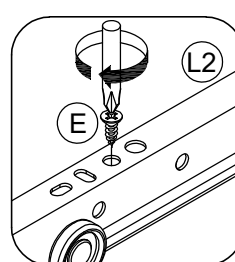
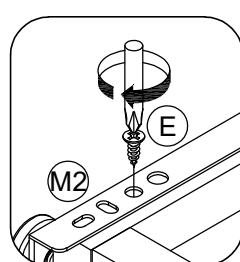
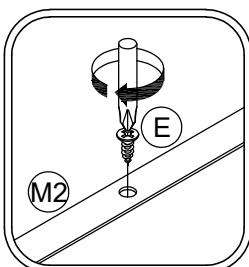
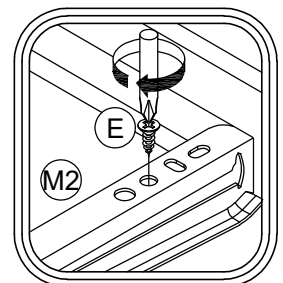
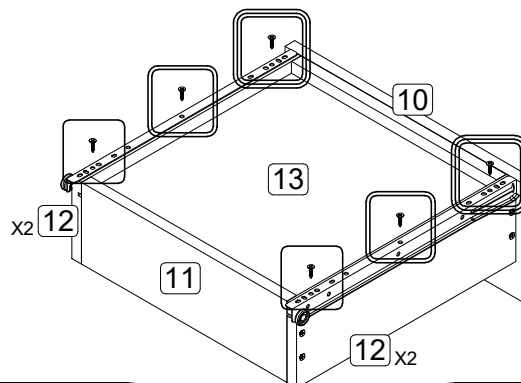
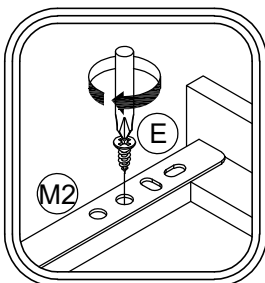
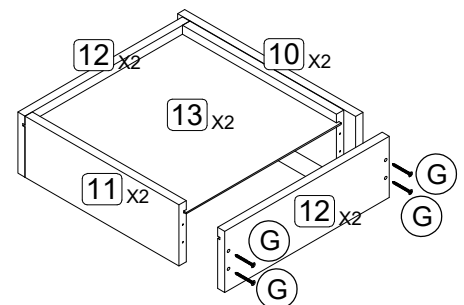
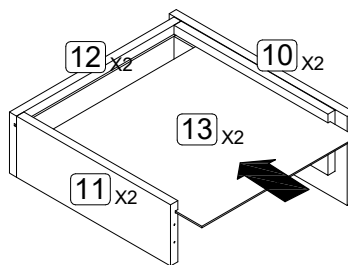
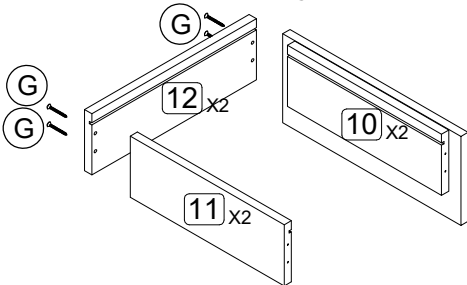

Step 11: Assemble the drawer in place along the drawer slides.

DO NOT use any power tools as this may damage the frame and will invalidate any claim.

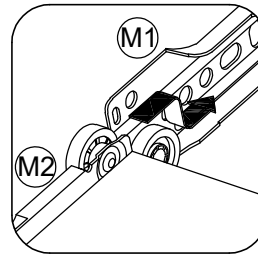
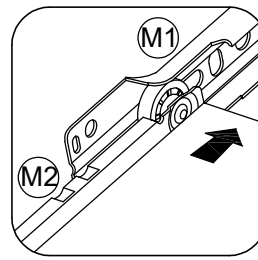
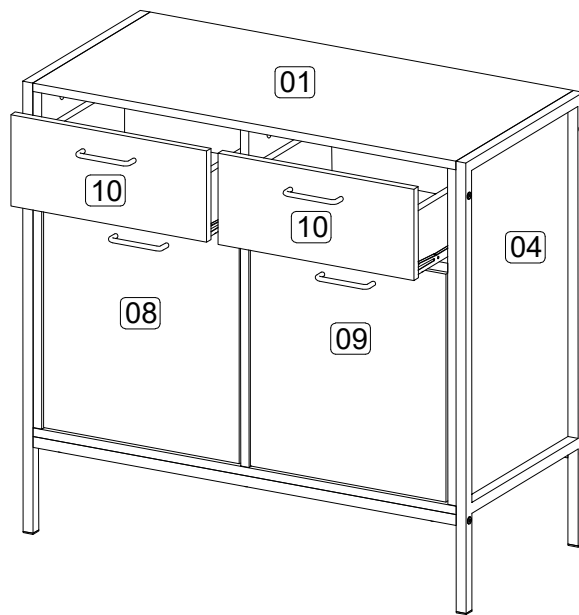

Step 12: To secure the item to the wall use hardware F, O and P using a screwdriver (not provided).

Then attach hardware part O to the panel (1) using hardware E with a screwdriver (not provided).

DO NOT use any power tools as this may damage the frame and will invalidate any claim.

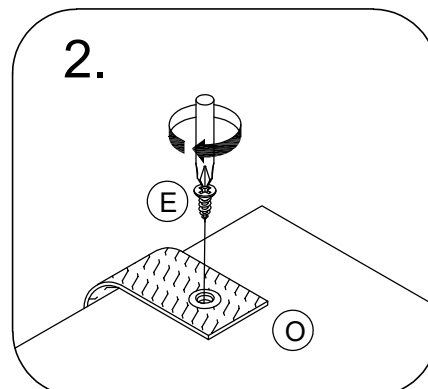
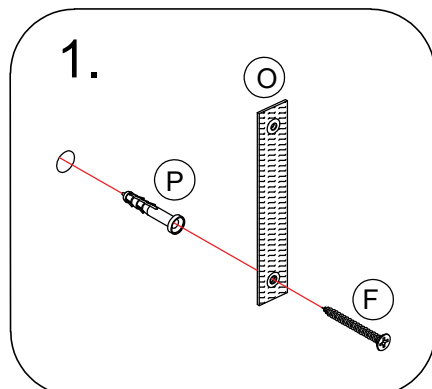

PLEASE NOTE that wall fixings are not supplied as different wall materials require different fixing devices. You must use fixings devices suitable for the type of wall you intend to mount product to. Ensure the head of any screw used has a diameter greater than the mounting hole and the fixing is safe and secure before use.

Birlea Furniture advise you use the wall straps provided to further enhance the safety of this product.

Additional Information:

- For complete product information, images and dimension diagrams please visit the website www.birlea.com
- If you have any issues with your item please contact the retailer directly you purchased it from who will be able to resolve any issues with Birlea.
- Why don't you send us photos of your assembled furniture to info@birlea.com to be shared in our #birleahome feature on instagram.



Birlea

Suppliers of inspiration